



AnyBODY™ Conduit Bodies

New!

Combination threaded IMC or rigid and set-screw EMT.

Copper-free aluminum die-cast. Five conduit bodies in one! Ships as an LB, but converts to a T, LL, LR, or C.



930 ships as LB

Table with columns: CATALOG NUMBER, UPC/DCI/NAED MFG #01 8997, TRADE SIZE, CUBIC INCHES, UNIT PKG, STD PKG, DIM A, DIM B, DIM C. Rows 930-935.

Refer to page H-2 for hub illustration

PATENT PENDING.



E48106 LR49636

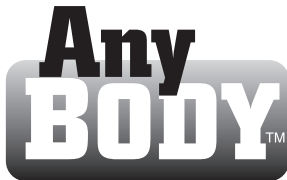
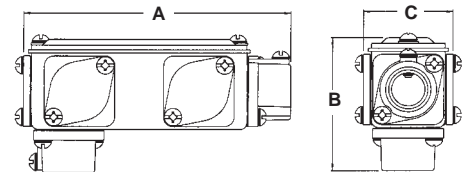

Converts to a...

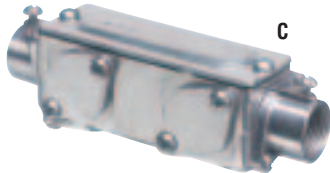

C

Threaded only for IMC or rigid.

Table with columns: CATALOG NUMBER, UPC/DCI/NAED MFG #01 8997, TRADE SIZE, CUBIC INCHES, UNIT PKG, STD PKG, DIM A, DIM B, DIM C. Rows 936-939.

PATENT PENDING.



E48106 LR49636



LL



LR



T

Image showing conversion of AnyBODY 930 to LR configuration. Includes labels: Threaded Flange, Cover Plate, Screwdriver. Includes numbered steps: 1. Remove cover plate. 2. Remove threaded flange. 3. Reinstall cover plate and flange in the appropriate opening to convert AnyBODY to the desired configuration.

COMPETITIVELY PRICED WITH LBs

Features and Benefits

- Meets NEC 2005 Section 314.16 Paragraph (C) (2) for Conduit Bodies with Splices, Taps, or Devices
Convenient and easy to use
Saves the time, space, and cost of stocking five different conduit bodies (T, LL, LR, C)
1/2" to 2" sizes are combination EMT/rigid — they're threaded for rigid, but also have a set-screw for use with EMT
Includes threaded flanges for three openings
Volume and wire fill marked inside bodies
Recessed O-rings under covers and flanges