

UL/CSA LISTED



# GARD-N-POST™

SUPPORTS & ENCLOSURES  
FOR OUTDOOR INSTALLATIONS

**A**  
Arlington

**Look  
Great**

# Outdoors!

## WITH **GARD-N-POST™** SUPPORTS & ENCLOSURES

Arlington's **Gard-N-Posts™** are the attractive, safe and easy way to install light fixtures and devices outdoors!

We offer a variety of styles, from 9" to 73" tall that function as supports or enclosures – or both!

Made of non-metallic, heavy-duty plastic, our damage-resistant Gard-N-Post holds up against abuse from lawn maintenance equipment.

Most have built-in stabilizers that deliver rigid support and require no assembly. The angle-cut at the bottom allows for easy access to underground wires\*.

Plus, the colorant runs throughout the post, so there's no chipping or loss of color.

For added convenience, **GP19**, **GP26** and **GP37** – our most popular sizes – come with a supplied separator so you can install power and low voltage outlets in the same post.

Some styles come with a metal grounding bushing in place, ready for the installation of an NPT fixture. And some have KO's that make them UL Listed enclosures.

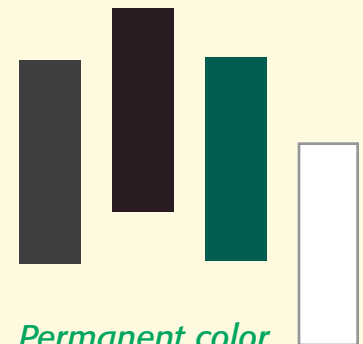
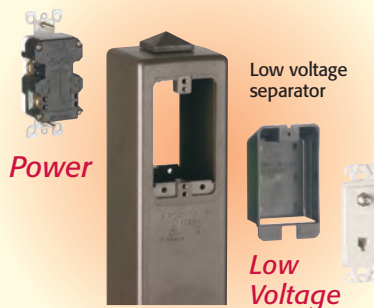

*Permanent color.  
No chipping!*

*GP19 • GP26 • GP37  
One post.  
Two openings.*

**Whatever your need,  
there's a Gard-N-Post to fit it!**

\* Not applicable to GPD9 deck/post mount style or the GPLN15GR low profile support.



Patented. Other patents pending.



# For Any Outdoor Application

USES

HEIGHT • CATALOG NUMBER

**Supports**  
for fixture(s)  
and/or GFCI

page **4**

**19.5"**  
GP19  
**26"**  
GP26



**Bollard Kit Support**  
for fixture  
and/or GFCI

page **8**

**35"**  
GPBK35



**Super Tall Support**  
for fixture  
and/or GFCI

page **6**

**37"**  
GP37 ▶  
**Optional**  
**18" extender**  
GPX18



**Low Profile Supports**  
for 2- and 3-wire  
light fixtures

page **10**

**19.5"**  
GPLN19  
w/ non-metallic bushing  
**15"**  
GPLN15GR ▶  
w/ non-metallic bushing  
**19.5"**  
GPL19 w/ metal bushing



**Low Profile Enclosure**  
with built-in  
weatherproof  
while-in-use cover

page **11**

**19.5"**  
GPD19



**Deck/Post Mount Support**  
for fixture  
and/or GFCI

page **7**

**9"**  
GPD9



**3-wire type Light Fixtures**  
for use with  
**GARD-N-POST™**

page **12**

GPI75B  
GPP60B  
GPP60LB  
GPF13B



# GARD-N-POST™

## Low Profile Support

**GP19 19.5"**

**GP26 26"**

**For any outdoor light fixture up to 18 lbs, w/ 1/2" or 3/4" NPT threads, and/or a GFCI wiring device**

- Openings on both sides of the post allow for back-to-back power – use the supplied low voltage separator to install power and low voltage outlets in the same post
- Built-in stabilizers need no assembly and deliver rigid support
- Designed for easy access to underground wiring
- Four 1/2" KOs for a UL Listed enclosure
- Four colors
- Competitively priced



UL Listed cover  
Removable for easy wire installation

**GP26**  
Taller design provides additional height for wiring devices and increased burial depth

Built-in stabilizers  
No loose parts.  
No assembly required.

Angle-cut base  
for easy access to underground wiring

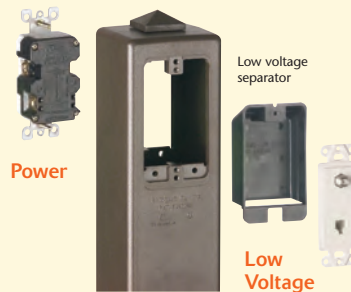

Patented.  
Other patents pending.

### GP19 19.5" Height

Item No.	UPC/DCI/NAED Mfg. #01 8997	Color	Unit Pkg	Std Pkg
<b>GP19B</b>	77086	Black	1	6
<b>GP19BR</b>	77087	Bronze	1	6
<b>GP19G</b>	77088	Green	1	6
<b>GP19W</b>	77089	White	1	6

### GP26 26" Height

Item No.	UPC/DCI/NAED Mfg. #01 8997	Color	Unit Pkg	Std Pkg
<b>GP26B</b>	77090	Black	1	6
<b>GP26BR</b>	77092	Bronze	1	6
<b>GP26G</b>	77094	Green	1	6
<b>GP26W</b>	77096	White	1	6

### Includes...

Installed 3/4" x 1/2" NPT metal reducing bushing, locknut with copper ground wire for fixture installation, (2) blank device plates, gaskets and screws, plug for top hole (when fixture is not installed), low voltage separator and removable KO plate.

For Light Fixture(s) and/or a GFCI



*More Convenient than Ever!  
Install a fixture – and your  
choice of Power and/or  
Low Voltage Outlets – Outside!*



**A**  
Arlington

**GP37 37"**  
Optional  
**GPX18 18" Extender**

**Our tallest Gard-N-Post supports most outdoor light fixtures, and/or a GFCI wiring device**

- Adaptable in the field for time clocks and disconnects
- Openings on both sides of the post – and the low voltage separator (supplied) allow for low voltage on one side, power on the other.
- Built-in stabilizers
- Two 1/2" KOs for a UL Listed enclosure
- Non-chipping colors
- UV rated plastic

**Add the Optional GPX18 to extend the GP37 in 18" increments – up to 73" tall.** Or cut the top of the extender to the desired height



◀ **GP37**  
Our tallest 2-piece Gard-N-Post assembles with PVC cement

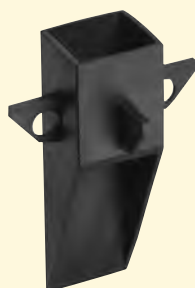

**GPX18** ▶  
Optional  
**18" Extender**

Extends the height of the GP37 up to 73"



CSA Listed with grounding lugs



**GP37 37" Height**

Item No.	UPC/DCI/NAED Mfg. #01 8997	Color	Unit Pkg	Std Pkg
<b>GP37B</b>	76153	Black	1	4
<b>GP37BR</b>	76154	Bronze	1	4
<b>GP37G</b>	76156	Green	1	4
<b>GP37W</b>	76155	White	1	4

**Includes...**  
Installed 3/4" x 1/2" NPT metal reducing bushing, locknut with copper ground wire for fixture installation, (2) blank device plates, gaskets and screws, plug for top hole (when fixture is not installed), low voltage separator and removable KO plate.

**OPTIONAL GPX18 18" Extender**

Item No.	UPC/DCI/NAED Mfg. #01 8997	Color	Unit Pkg	Std Pkg
<b>GPX18B</b>	76157	Black	1	4
<b>GPX18BR</b>	76158	Bronze	1	4
<b>GPX18G</b>	76160	Green	1	4
<b>GPX18W</b>	76159	White	1	4



GP9B shown with light fixture GPP60B



**GP9**  
Two-piece Gard-N-Post



### GPD9 9"

**Low profile support for deck or post mounting of most light fixtures and/or a GFCI wiring device**

- Non-metallic two-piece design
- UV rated plastic for long outdoor life
- Metal grounding bushing assembly included
- Two 1/2" KOs for a UL Listed enclosure
- Includes plug for top for device-only installations
- Four permanent colors
- UL and CSA Listed (CSA w/ grounding lug)
- Competitively priced!

See page 12 for Light Fixture details

**Look Great Outdoors!**

### GPD9 9" Height

Item No.	UPC/DCI/NAED Mfg. #01 8997	Color	Unit Pkg	Std Pkg
GPD9B	76161	Black	1	6
GPD9BR	76162	Bronze	1	6
GPD9G	76164	Green	1	6
GPD9W	76163	White	1	6

### Includes...

Installed 3/4" x 1/2" NPT metal reducing bushing, locknut with copper ground wire for fixture installation, blank device plate, gasket and screws, plug for top hole (when fixture is not installed), removable KO plate and mounting base.



**Arlington**

# GARD-N-POST™

## Low Cost Bollard Kit

### GPBK35 35"

#### Gard-N-Post support post with pagoda-style light fixture

- Perfect for decks, boat docks and concrete walkways
- Square pagoda-style light fixture matches the shape of the Gard-N-Post™
- Fixture has a standard lamp socket that accommodates a variety of lamp types
- Back-to-back openings in the post, and the low-voltage separator give you the option of installing power in one side, and low-voltage in the other – or high voltage devices in both
- Two combination KO plates provide a UL Listed enclosure
- Colors: black, bronze
- Low cost bollard!
- Easy installation– includes everything you need to install it, except anchor bolts and caulking



Metal Support Post

- 1 Attaches easily to surface

**Easy to install!**



35" Non-metallic Gard-N-Post

- 2 The non-metallic Gard-N-Post slides over the metal support post.

Both posts are held firmly in place with the supplied screws (see below).



Decorative Curb

- 3 Place decorative curb over Gard-N-Post. Slide it down to cover the installation.

Gard-N-Post



- 4 Press fit spacer to base of lamp.

Spacer



- 5 Install pagoda light to post with locknut inside the top of the post. Wire fixture.

Recommended anchors (not included): Concrete: (4) 3/8" x 2-1/2" Tapcons®  
Cast-in-place concrete: (4) 3/8" anchor bolts  
Wood deck: (4) 3/8" anchor bolts w/ nuts & washers

#### Bollard Kit 35" Height

Item No.	UPC/DCI/NAED Mfg. #01 8997	Color	Unit Pkg	Std Pkg
GPBK35B	77040	Black	1	1
GPBK35BR	77041	Bronze	1	1

#### Kit includes...

Gard-N-Post and metal stabilizer, curb, pagoda light fixture and decorative spacer, (2) blank device plates with gaskets and screws, low voltage separator and removable KO plate with screws.

**Pagoda Light Fixture** compliments Arlington's Gard-N-Post line

*Sold separately*

Item No.	UPC/DCI/NAED Mfg. #01 8997	Color	Unit Pkg	Std Pkg
GPP60LB	77046	Black	1	4
GPP60LBR	77047	Bronze	1	4

Fixture uses a 40 watt halogen, 40 watt incandescent, or a 13 watt fluorescent lamp. Lamp not included.



The Square Light on a Square Post Looks Great!



**GPBK35B**  
Bollard Kit  
(black)

*Perfect for  
Concrete Walkways  
and Boat Docks!*



**A**  
**Arlington**

# GARD-N-POST™

Just for Light Fixtures • Low Cost!

**GPLN 19.5"**  
**GPLN 15"**  
**GPL 19.5"**

**Gard-N-Post**  
**low profile supports**  
**just for 2- and 3-wire**  
**fixtures**

Installing an outdoor light fixture is easier, and less expensive with Arlington's low cost Gard-N-Posts.

The GPLN series low profile support is designed for 3-wire light fixtures. They come with a 3/4" NPT threaded opening, and an installed 3/4 x 1/2 non-metallic reducing bushing for use with 1/2" or 3/4" NPT fixtures.

- Installed cover
- Permanent colors – No chipping
- Heavy-duty – Resists damage from lawn mowers and other lawn maintenance equipment
- UV rated plastic for long outdoor life
- UL and CSA Listed

## GPLN19

Non-metallic bushing for 3-wire fixtures only



3/4" x 1/2" reducing bushing w/ 1/2" NPT opening

Cover with 1/2" KO or photocell

Built-in stabilizers  
No loose parts.  
No assembly required.

## GPLN15GR

Non-metallic bushing for 3-wire fixtures only



## GPL19

Metal bushing with ground wire for 2- or 3-wire fixtures



**Our Absolutely LOWEST COST Gard-N-Post**



**GPL19B**  
Shown with light fixture GPI75B

Patented.  
Other patents pending.

### GPLN19 19.5" Height • Non-Metallic Bushing

Item No.	UPC/DCI/NAED Mfg. #01 8997	Color	Unit Pkg	Std Pkg
GPLN19B	76190	Black	6	6
GPLN19BR	76192	Bronze	6	6

### GPLN15GR 15" Height • Non-Metallic Bushing

Item No.	UPC/DCI/NAED Mfg. #01 8997	Color	Unit Pkg	Std Pkg
GPLN15GR	76181	Gray	10	

GPLN19 & GPLN15GR  
Include: Access panel cover, gasket, 3/4" x 1/2" NPT non-metallic bushing for fixture installation.

### GPL19 19.5" Height • Metal Bushing

Item No.	UPC/DCI/NAED Mfg. #01 8997	Color	Unit Pkg	Std Pkg
GPL19B	77000	Black	1	6
GPL19BR	77001	Bronze	1	6
GPL19G	77002	Green	1	6
GPL19W	77003	White	1	6

Includes: Access panel cover, gasket, installed 3/4" x 1/2" NPT metal grounding bushing and locknut with copper ground wire for fixture installation.

# GARD-N-POST™

## Enclosure w/ Weatherproof in-use Cover



GPD19B

*Why install boxes like this?...*



**New Features  
for EXTRA-DUTY  
Code Compliance**

**Reinforced Hinge** allows cover to comply with extra-duty code requirements of 2011 NEC

**Extra-Duty Built-in Weatherproof Cover**

**UL Listed Enclosure**

### GPD19 19.5"

**Low profile enclosure with built-in, clear weatherproof while-in-use cover**

Arlington's GPD19 Gard-N-Post enclosure costs about the same as multiple piece assemblies, but it looks a lot better, and it's faster and easier to install.

- Ships with a clear, extra-duty weatherproof in-use cover, GFCI and duplex wall plate – no gasket required
- Four permanent, damage-resistant colors
- Made of heavy-duty, UV-rated plastic
- 19.5" tall
- UL Listed enclosure – Meets 2011 NEC extra-duty code requirements

*...when you can*

**Look Great Outdoors!**

### GPD19 19.5" Height

Item No.	UPC/DCI/NAED Mfg. #01 8997	Color	Unit Pkg	Std Pkg
GPD19B	77020	Black	1	6
GPD19BR	77021	Bronze	1	6
GPD19G	77022	Green	1	6
GPD19W	77023	White	1	6

Includes: Gard-N-Post with built in weatherproof while-in-use cover, GFCI wall plate



**Arlington**

# GARD-N-POST™

Decorative Light Fixtures • Sold Separately

## Decorative 3-wire type light fixtures for use with our Gard-N-Post line

- Powder coated color match
- For heavy-duty commercial or residential use
- 1/2" NPT fixture
- Adds safety and security
- Perfect for illuminating signs, flagpoles, walkways, buildings, driveways, yards and recreational areas

### Lamp Up to 75 watt, flood

Item No.	UPC/DCI/NAED Mfg. #01 8997	Color	KO Size	DIM A	DIM B	DIM C	Unit Pkg	Std Pkg
<b>GP175B</b>	77042	Black	1/2"	4.062	4.062	8.135	1	4
<b>GP175BR</b>	77043	Bronze	1/2"	4.062	4.062	8.135	1	4

Uses a 75 watt PAR 16 or a 50 watt PAR 20 halogen lamp. Lamp not included.

### Lamp 13 watt, fluorescent • 2-lamp fixture

Item No.	UPC/DCI/NAED Mfg. #01 8997	Color	KO Size	DIM A	DIM B	DIM C	Unit Pkg	Std Pkg
<b>GPF13B</b>	77044	Black	1/2"	8.500	6.300	5.300	1	4
<b>GPF13BR</b>	77045	Bronze	1/2"	8.500	6.300	5.300	1	4

Uses two 13 watt fluorescent lamps (included). Lamp # PL-S27

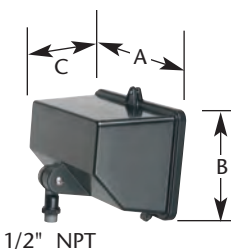
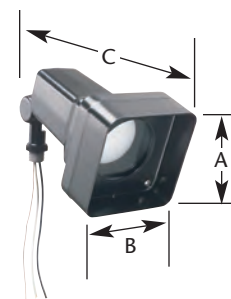

## Pagoda-style, 3-wire type light fixture

- Durable cast aluminum
- 3/4" NPT fixture
- Made for incandescent, halogen and energy-saving compact fluorescent lamps (Lamps not included)

### Lamp Incandescent, halogen or compact fluorescent

Item No.	UPC/DCI/NAED Mfg. #01 8997	Color	DIM A	DIM B	DIM C	Unit Pkg	Std Pkg
<b>GPP60B</b>	77046	Black	4.750	4.750	8.750	1	4
<b>GPP60BR</b>	77047	Bronze	4.750	4.750	8.750	1	4

Uses a 40 watt halogen, 40 watt incandescent, or 13 watt fluorescent lamp. Lamp not included.

**GPP60B**

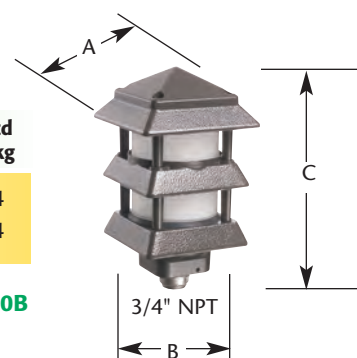

### Lamp Incandescent, halogen or compact fluorescent

Item No.	UPC/DCI/NAED Mfg. #01 8997	Color	DIM A	DIM B	DIM C	DIM D	Unit Pkg	Std Pkg
<b>GPP60LB</b>	04605	Black	3.600	4.250	6.070	8.573	1	4
<b>GPP60LBR</b>	04606	Bronze	3.600	4.250	6.070	8.573	1	4

Uses a 40 watt halogen, 40 watt incandescent, or 13 watt fluorescent lamp. Lamp not included.

**GPP60LB**

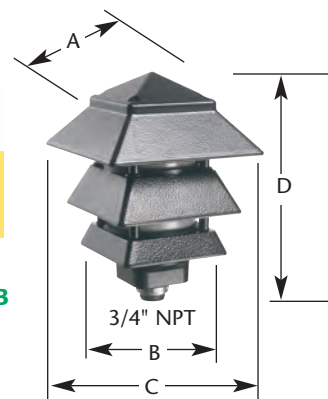

# Arlington

1 Stauffer Industrial Park  
Scranton, PA 18517  
**800/233.4717**  
**Fax 570/562.0646**  
[www.aifittings.com](http://www.aifittings.com)

©2005, 2006 Arlington Industries, Inc.



GP0506/50M

Distributed by