

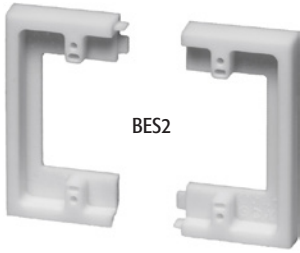

BES1



BES2



BES2C

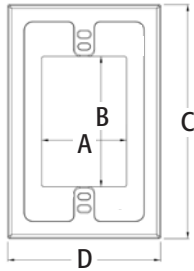

BES1

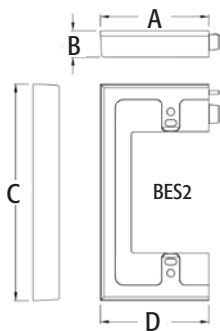

BES2

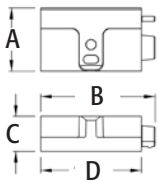

Non-Metallic Box Extender

Box too shallow to install that dimmer switch? Arlington's non-metallic box extender is ideal for fitting larger items, like a dimmer switch, into a shallow box. Extends shallow boxes 5/8".

CATALOG NUMBER	UPC/DCI/NAED MFG #018997	DESCRIPTION	UNIT PKG	STD PKG	DIM A	DIM B	DIM C	DIM D
BES1	89760	1-Gang	1	10	1.85	2.85	5.117	3.336
BES2	89777	2-Gang	1	10	2.574	.625	5.117	2.574
BES2C	89791	1-Gang	1	25	1.127	2.062	.625	1.8112

 **MADE IN USA.**
E170558 LR49636

FEATURES AND BENEFITS

- Fast, easy and convenient, so you save time and money!
- Finishes with any standard or mid size wall plate
- Paintable
- UL/CSA listed

Adds to existing box volume:

- BES1 adds 5.3 cu. inches
- BES2 adds 10.5 cu. inches
- Each pair of BES2C couplers adds an additional gang and 3.5 cubic inches.

