

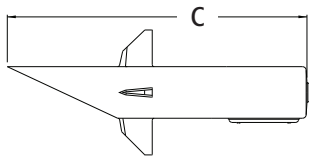

GP19BR

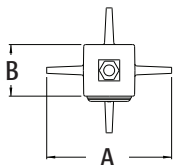

GP26G



**COLOR CHART**

WHITE

BRONZE

GREEN

BLACK

**19.5" & 26" Supports for Outdoor Light Fixtures**

For installing a light fixture and/or GFCI devices outdoors. UV rated plastic for long outdoor life. Four non-chipping colors.

CATALOG NUMBER	UPC/DCI/NAED MFG #018997	COLOR	UNIT PKG	STD PKG	DIM A	DIM B	DIM C
GP19B	77086	Black	1	6	8.110	3.361	19.470
GP19BR	77087	Bronze	1	6	8.110	3.361	19.470
GP19G	77088	Green	1	6	8.110	3.361	19.470
GP19W	77089	White	1	6	8.110	3.361	19.470
GP26B	77090	Black	1	6	8.110	3.361	26.000
GP26BR	77092	Bronze	1	6	8.110	3.361	26.000
GP26G	77094	Green	1	6	8.110	3.361	26.000
GP26W	77096	White	1	6	8.110	3.361	26.000

**MADE IN USA.**  
E170558 LR49636

Add suffix "GC" to Catalog # when ordering in Canada, for example GP19BGC. CSA listed with grounding lug.

**FEATURES AND BENEFITS**

- Low voltage separator provided for Power use on one side and Low Voltage on the other (phone, security, & cable TV)
- Molded in color is permanent, unlike painted posts where lawn equipment chips the color off
- GP26's taller design provides additional height for wiring devices and increased burial depth
- Angle cut post for easy access to underground wiring
- Built in stabilizers need no assembly and provide rigid support
- Openings on both sides of the post for back to back power
- GP19's stabilizers offer greater use of above ground height
- (2) 1/2" KOs for a UL Listed enclosure



**INCLUDES**

Installed 3/4" x 1/2" NPT metal reducing bushing, locknut with copper ground wire for fixture installation, blank device plate, gasket & screws, plug for top hole (when fixture is not installed), removable KO plate, and mounting base.

Scan For Video



**OPENINGS ON BOTH SIDES!**



Install one or two GFCI Wiring Devices with weatherproof cover.



Or add the Low Voltage Separator and run Low Voltage on one side and Power on the other!

