

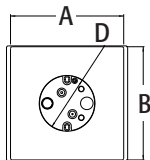

FB450



FB900



FB450

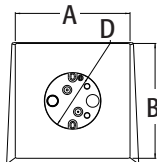
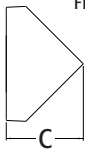

FB900

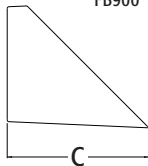

FB450



FB900

THE SIMPLE WAY TO A GREAT FINISH!

Fan & Fixture Mounting Boxes for New Construction

Mounts fans and fixtures on sloped or cathedral ceilings.

CATALOG NUMBER	UPC/DCI/NAED MFG #018997	DESCRIPTION / CU. IN.	UNIT PKG	STD PKG	DIM A	DIM B	DIM C	DIM D
FB450	75240	Fits sloped ceilings up to 45°/14.5 cu. in.	1	6	7.881	7.881	9.729	3.875
FB900	75250	Fits cathedral ceilings 80° or greater/14.5 cu. in.	1	6	7.881	7.881	6.364	3.875



MADE IN USA.

Refer to chart on page R-25 for load ratings and number of single conductors.

FEATURES AND BENEFITS

- No loose parts to misplace totally self contained!
- Large 8" square mounting surface handles newer fans with larger canopies
- FB900 has taller sides to fit cathedral ceilings with angles greater than 80°
- Fan/fixture installation screws are parked, ready for easy fan/fixture bracket installation!
- UL rated: 70 lb fan, 200 lb fixture; CSA rated: 50 lb fan/fixture
- Textured paintable finish
- Installs quickly and securely

FAN/FIXTURE BOX INCLUDES

Mounting block with built in electrical box, installed NM94 cable connector, two installation screws ready to tighten, and two parked in place fan/fixture bracket installation screws (ready for installer).



INSTALLATION INSTRUCTIONS

FB450



Trim a 2x8, approximately 18" long. Allow the panel to extend 9-11" past the FB450.

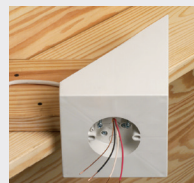

Install the FB450 on the 2x8 using the (2) #8 x 1-1/2" long parked screws provided.

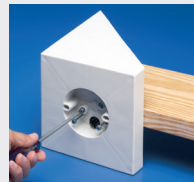

Score and trim the FB450 as necessary, keeping bottom of box level. (Short side needs to touch rafter.) Trim wood as necessary to butt it to rafter. Nail or screw assembly to rafter.



Push the cable through the installed cable connector in the electrical box.

FB900



Cut a 2x4 approximately 14" long to span the pitched rafters.

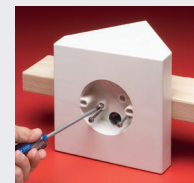

Install the FB900 in the center of the cut 2x4 using the (2) #8 x 1-1/2" long parked screws provided.



Position the 2x4 with the FB900 attached to the angled rafters, keeping bottom of box level, and the short sides of the box touching the angled rafters. Nail or screw the assembly spanning both angled rafters.

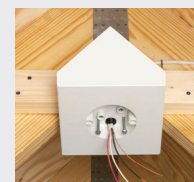

Push the cable through the installed cable connector in the electrical box.

Note: Install fan or fixture (not included) in accordance with manufacturer's instructions and all local applicable electrical codes, using the parked screws provided.