

Fan & Fixture Mounting Box with Adjustable Brackets for New Construction

Mounts fans and fixtures on cathedral ceilings between two framing members for perfect centering within room.

CATALOG NUMBER	UPC/DCI/NAED MFG #018997	DESCRIPTION / CU. IN.	UNIT PKG	STD PKG	DIM A	DIM B
FBX900	75224	Adjustable; Fits cathedral ceilings 80° or greater/14.5 cu. in.	1	1	2.300	13.200



For fan/fixture box information, refer to FB900 on page R-16. Refer to chart on page R-25 for load ratings and number of single conductors.

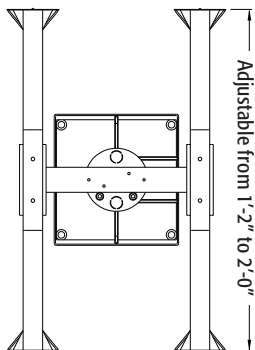
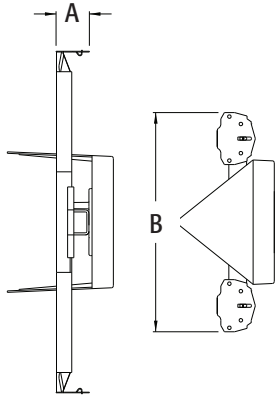

FEATURES AND BENEFITS

- UL rated: 70 lb fan/fixture; CSA rated: 50 lb fan/fixture
- Expandable brackets hold box securely between joists no need to cut and nail 2x4s to center the fan or fixture
- Allows fans/fixtures to be perfectly centered within room
- Fan/fixture installation screws are parked and ready for easy fan/fixture bracket installation!
- Large, 8" square mounting surface handles newer fans with larger canopies
- No loose parts to misplace, totally self contained!
- Installs quickly and securely
- Includes a template to level and position brackets between rafters
- Taller sides fit cathedral ceilings with angles greater than 80°
- Textured paintable finish

FAN/FIXTURE BOX INCLUDES

Expandable brackets with mounting screws, screws to adjust box position, mounting block with built in electrical box, installed NM94 cable connector, and two parked in place fan/fixture bracket installation screws (ready for installer).



Scan For Video



INSTALLATION INSTRUCTIONS

Remove and use these screws to attach bracket ends to rafters

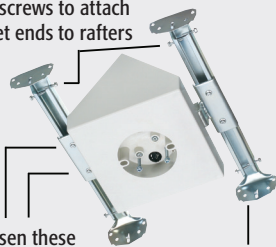

Loosen these screws to expand brackets and position box between rafters

"Tooth" holds brackets temporarily in place on rafter



For proper fan/ fixture installation, use supplied template to level and position brackets between rafters. Remove captive screws on sides of brackets and use to attach FBX900 assembly to rafters.

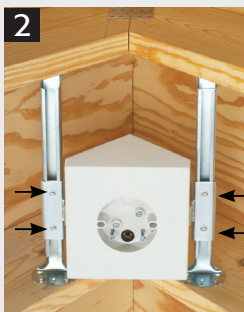

Note: Install fan or fixture (not included) in accordance with manufacturer's instructions and all local applicable electrical codes, using the parked screws provided.

Loosen the screws noted in first illustration. Slide box to center it between rafters. Tighten screws. Install wires.

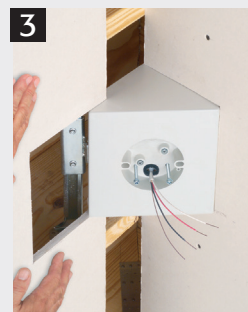

Cut and position drywall to fit around the box. (Note: captive screws in box.) Install fan or fixture per manufacturer's instructions using captive installation screws.