

FER102 RETROFIT GANGABLE BOX

Contents:

- (2) FER102 - Retrofit Sections
- (2) NM94 Cable Connectors

34.0 IN³ VOLUME

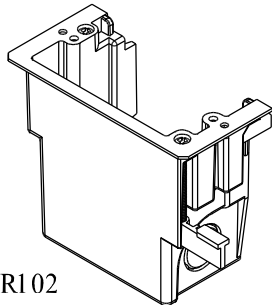

FER102



NM94 Cable
Connector

FER102C (SOLD SEPERATELY) ADDS
17.5 IN³ VOLUME PER GANG

EXAMPLE:

3-GANG	51.5 IN ³ VOL.
4-GANG	69.0 IN ³ VOL.
5-GANG	86.5 IN ³ VOL.
6-GANG	104.0 IN ³ VOL.
7-GANG	121.5 IN ³ VOL.
8-GANG	139.0 IN ³ VOL.

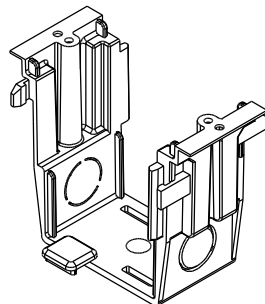

FER102C (Adds 17.5 IN³)
(Sold Separately)

If you have any questions or if parts are missing Please call our Customer Service Department at 1-800-233-4717. Do not call or return this product to your local store or distributor.

Assembly Instructions:

1. Attach FER102 sections together by tilting each piece as shown and by inserting the tabs into the slots in bottom of each piece. Then rotate and snap the sections together along the sides of each piece.
2. If necessary, use same assembly method to attach FER102C center sections (sold seperately) to create 3-10 Gang Installations.

CUT-OUT DIMENSIONS:

2-GANG	3-3/4" HIGH × 3-7/8" WIDE
3-GANG	3-3/4" HIGH × 5-11/16" WIDE
4-GANG	3-3/4" HIGH × 7-1/2" WIDE
5-GANG	3-3/4" HIGH × 9-5/16" WIDE
6-GANG	3-3/4" HIGH × 11-1/8" WIDE
7-GANG	3-3/4" HIGH × 12-15/16" WIDE
8-GANG	3-3/4" HIGH × 14-3/4" WIDE

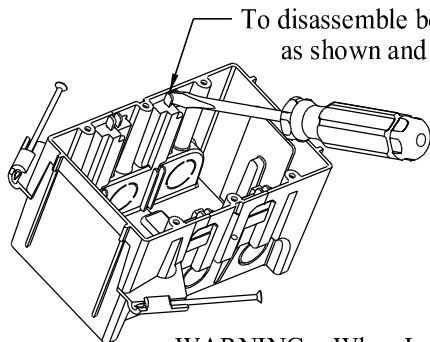
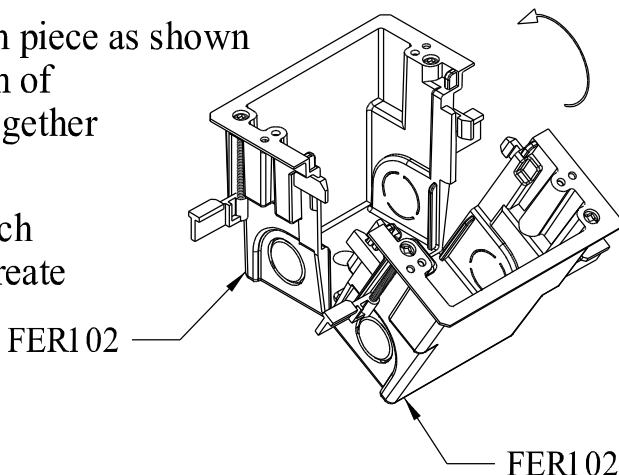

To disassemble box - insert a flat blade screw driver between ribs as shown and rotate screw driver. Repeat on opposite side.

(FEN102 Nail-On Gangable Box shown -
Procedure is the same for the entire series of
FER102 Boxes)

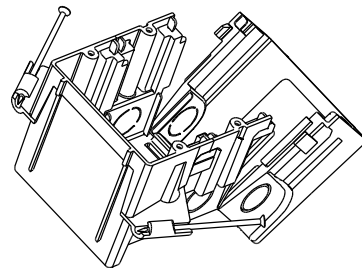

WARNING: When Installing Box, Make sure power is OFF at main panel box before installing.

NOTE: All Wiring Must be According to NEC, State and Local Codes.

The manufacturer and distributor warrant this product for material and workmanship only, and shall not be liable for any special incident or consequential damages or for damages or loss caused by improper use or installation.