

SNAP²IT[®] MC Cable Connectors

NEW!

NEW!
more on
reverse

3/4" KO • Easy Snap-in Cable Insertion • NO TOOLS!



407AST
Snap on to cable,
Snap in to box

**Easy
installation
into box!**
Snap in or Locknut...

387AST, 407AST
SNAP assembly into box



387A with
locknut
removed
threaded onto
'LB' conduit
body

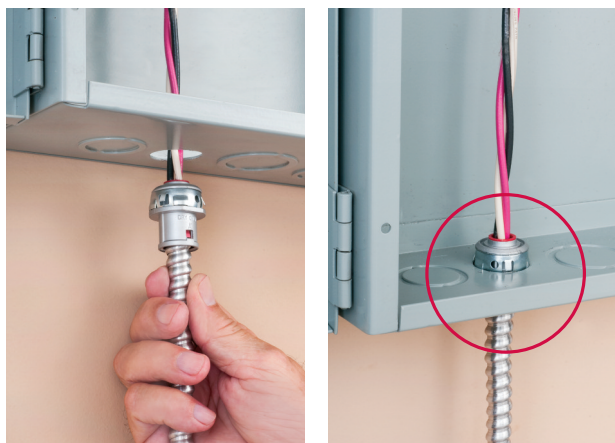

387A, 407A Installation of assembly with LOCKNUT

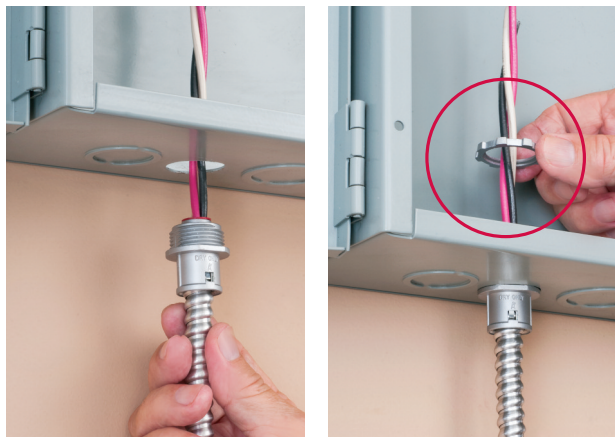

Patented

Arlington's new one-piece **SNAP²IT[®]** fittings for 3/4" knockouts make fitting-on-cable installations easier than ever.

NO TOOLS! Save time with easy snap-in installation. Snap the fitting onto the cable and twist clockwise.

To SNAP the assembly into the box, use a 387AST or 407AST fitting.



407AST back

If you prefer a LOCKNUT for installing the assembly into the box, use the 387A or 407A.



407A back

The red tinting in the 407A and 407AST indicates our 'OPEN TANG' design, meaning there's more room inside the fitting for easy insertion of wires.

- **Widest total cable ranges**
14/2 to 10/3
- **Widest variety of cables**
For AC, MC, HCF, MC continuous corrugated aluminum cable, MCI-A cables (steel and aluminum), AC90 and ACG90
- **Secure installation** No pullout
- **Easy, screwdriver removal** from box
Connector is reusable
- **Fully assembled – Ready to use**
Insulated throat included



Arlington[®]

1 Stauffer Industrial Park
Scranton, PA 18517
800/233.4717 • Fax 570/562.0646
www.aifittings.com

SNAP2IT® MC Cable Connectors

SNAP Assembly into Box or Install with Locknut

| CATALOG NUMBER | UPC/DCI/NAED MFG. #018997 | DESCRIPTION SNAP IN FITTINGS | CABLE TRADE SIZE | KO SIZE | CABLE (OD) OUTSIDE DIA. | UNIT PKG | STD PKG |
|---|---------------------------|------------------------------|------------------|---------|-------------------------|----------|---------|
| SNAP2IT® snaps onto cable • LOCKNUT ATTACHMENT | | | | | | | |
| 387A | 11430 | SILVER TINT inside | 3/8" | 3/4" | .405 to .605 | 50 | 500 |
| 407A | 11432 | RED TINT Open Tang Design | 3/8" | 3/4" | .480 to .605 | 50 | 500 |

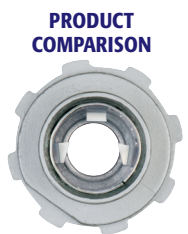

387A, 387AST
SILVER TINT inside

RED TINT inside means OPEN TANG Design

...meaning there's more room inside for easy insertion of wires. And it's easier than ever to snap the fitting into the box.

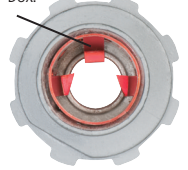

407A, 407AST

| SNAP2IT® at both ends of fitting • SNAP ONTO CABLE, SNAP INTO BOX | | | | | | | |
|--|-------|---------------------------|------|------|--------------|----|-----|
| 387AST | 11431 | SILVER TINT inside | 3/8" | 3/4" | .405 to .605 | 50 | 500 |
| 407AST | 11433 | RED TINT Open Tang Design | 3/8" | 3/4" | .480 to .605 | 50 | 500 |



CABLE SIZES

387A, 387AST
14/2 and 12/2 w/ and w/o ground,
14/3, 14/4, 12/3, 12/4, 10/2, 10/3

407A, 407AST
14/3, 12/2 and 12/3 w/ and w/o ground,
14/4, 12/4, 10/2, 10/3



407A with locknut removed threaded into a pull elbow



387A with locknut removed threaded into a 'T' conduit body

EASY SCREWDRIVER REMOVAL

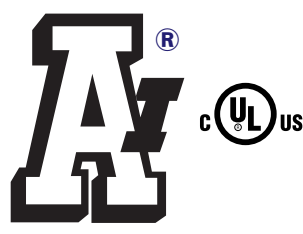
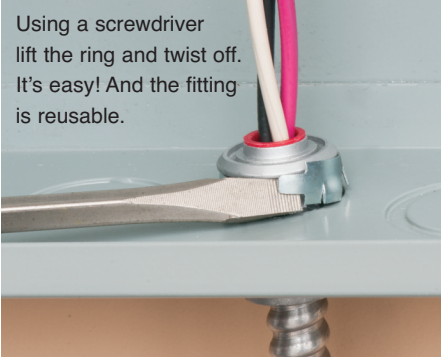

Arlington®

1 Stauffer Industrial Park
Scranton, PA 18517
800/233.4717 • Fax 570/562.0646
www.aifittings.com

Distributed by