

NEW!
More on
reverse

COMMERCIAL GRADE Box Extenders

Trimable • Listed • Extends Set Back Boxes Up to 1-1/2 inches

Heavy-duty Non-metallic Box Extender with Galvanized Steel Support

NEW! COMMERCIAL GRADE

NEW! Two-gang BE2XLS

BE1XLS
Single gang as shipped

Ready for use with Maxi Plates...

Trimable for use with Mid- and Standard Wall Plates

Trim along line with snips for Mid-size Cover Plates

Standard Cover Plate Cutting guideline

Ready for installation of standard wall plate

Arlington's heavy duty, commercial-grade Box Extenders save time! They're convenient too.

They *extend* set back metallic and non-metallic electrical boxes *up to 1-1/2"*, and work with maxi, midi and standard wall plates.

BE1XLS and **BE2XLS** ship ready to use with a maxi cover plate – great for hiding poorly cut drywall. They're also trimmable for use with mid-size and standard wall plates.

- Non-metallic box extender with galvanized steel support plate

- Levels, supports wiring devices; protects wires against damage and stripping

- **2-Hour Fire Rating**
- cULus Listed



If the edge of the box, plaster ring or box extender will be set back from the finished surface

LESS THAN 1/4" use our

NEW Device Support Plates

(see reverse)

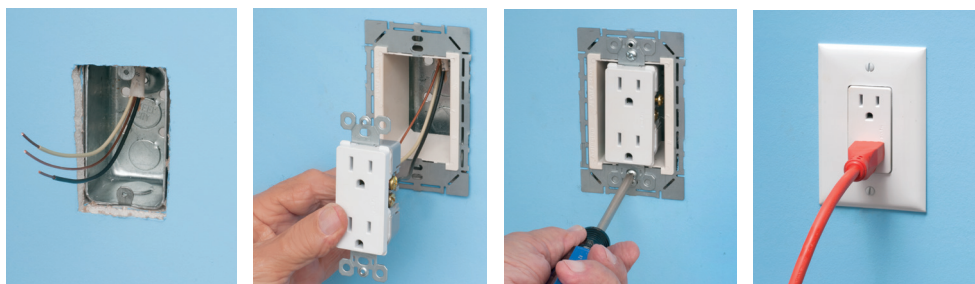

Patent pending



Arlington®

1 Stauffer Industrial Park
Scranton, PA 18517
800/233.4717 • Fax 570/562.0646
www.aifittings.com

Catalog Number	UPC/DEI/NAED Mfg. #018997	Description	Unit Pkg	Std Pkg
----------------	---------------------------	-------------	----------	---------

BE1XLS	40172	Single Gang Heavy duty, Non-metallic Box Extender	20	20
BE2XLS	99331	Two-Gang Heavy duty, Non-metallic Box Extender	10	10

Commercial Grade w/ galvanized steel support plate • Extends set back boxes up to 1-1/2"

**TWO HOUR
FIRE RATING**

© 2024 Arlington Industries, Inc.